

Technical Data:

Pin (outer sleeve): Brass, machined CuZn38Pb2
 Clip (Contact 4 Finger): Beryllium copper, heat treated
 Insulator body (black): PPS polyester UL94V-0 electrical
 Current rating: 2 Amps/contact max.
 Mating pin Ø: 0.305/0.483mm
 Force: (polished steel gauge Ø0.38mm)
 -Insertion: 0.5N typ
 -Withdrawal: 0.2N typ
 Mechanical life: min 100 cycles
 Contact resistance: 10mΩ/contact
 Insulation resistance: 1000M at V=100V
 Operating voltage : 60 AC/DC
 Soldering temperature: +255°C for 5s

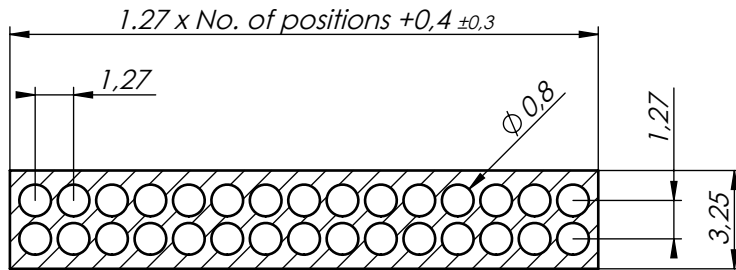
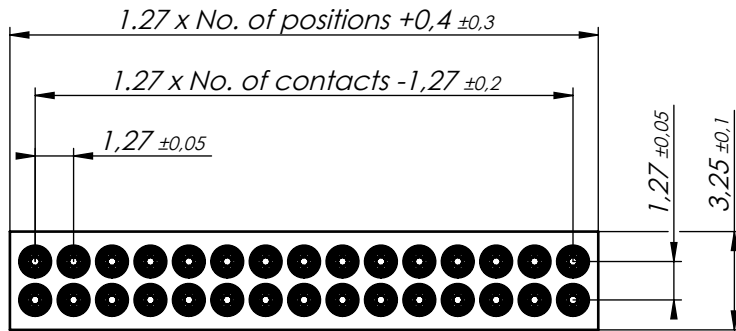

Recommended
PCB Layout (±0.05)

Order code

BL2-###-G410/05-##/12

No. of contacts
004 to 100

Contact plating

- 55 - Gold flash
- 66 - 0.25µm Gold
- 77 - 0.40µm Gold
- 95 - Tin/Gold flash (standard)
- 99 - Tin

Mate with pin header: SL2-###-G220/02-##/12

<p>A4H Scale 4:1</p> <p>UNLESS OTHERWISE SPECIFIED: DIMENSIONS ARE IN MILLIMETERS GENERAL TOLERANCES ISO 2768m</p> <p>patented</p> <p>The information contained in this drawing is proprietary to E-tec Interconnect AG and shall not be reproduced or disclosed in whole or in part or used for any design or manufacture except where such user possesses direct, written authorization from E-tec Interconnect AG</p>	REV 0 Modif:			Remark:	
	DRAWN	mga			10.08.2024
	REV'D	-			-
	APPV'D	mga			10.08.2024
Name Date			<p>"E-tec order code"</p> <p>BL2-###-G410/05-##/12</p>		