

REV.	DESCRIPTION	DATE	DRAWN
A	New	10.01.2017	Ronny

Order Code
MBC-xxx-QFH38-xx/11X

Packing Options

- C = tube
- G = reel

Plating

- 96 = tin / gold 5µ" (standard)
- Options:
- M95 = matte tin / gold flash
- 57 = gold flash / gold 10µ"

No. of Pin	Dimension mm				
	A	B	C	D	E
012	12,70	9,37	8,37	6,35	10,77
026	21,59	18,26	17,26	15,24	19,66
050	36,83	33,50	32,50	30,48	34,90
068	48,26	44,93	43,93	41,91	46,33
080	55,88	52,55	51,55	49,53	53,95
Other on request					

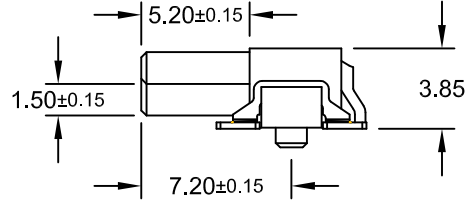
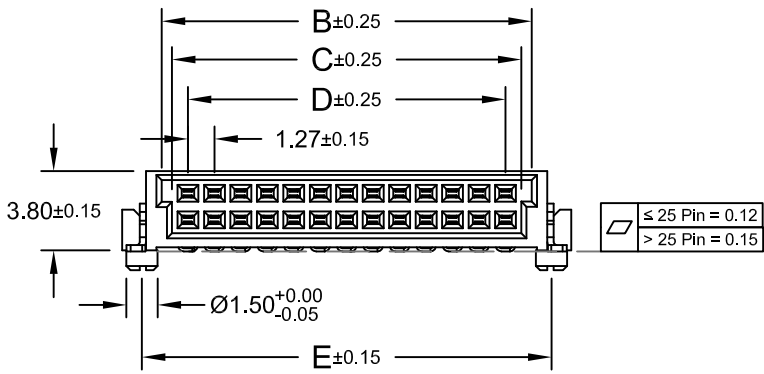
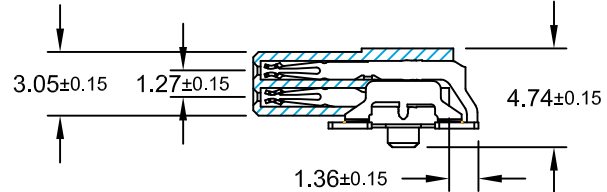
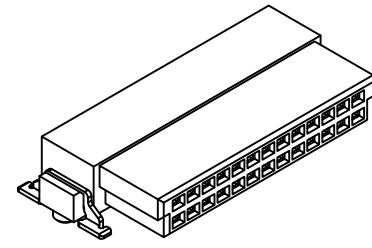
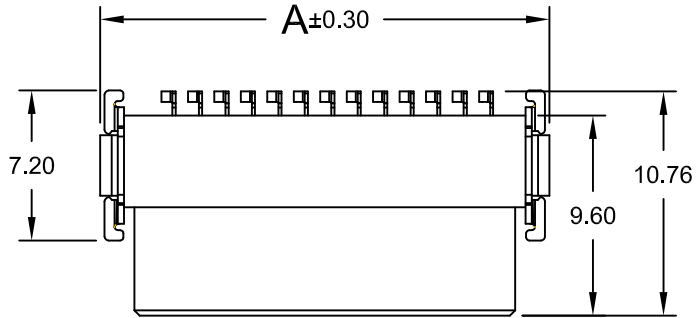

Specifications

Electrical

Current rating:

Current rating per contact	temperature		
	20°C	70°C	100°C
12 contact	1,6A	1,1A	0,7A
26 contact	1,3A	0,9A	0,6A
50 contact	1,1A	0,8A	0,5A
68 contact	1,0A	0,8A	0,5A
80 contact	1,0A	0,8A	0,5A

Insulation resistance: 1000MΩ min.
Contact resistance: 30mΩ max.
Withstanding voltage: 500V AC



Material

Contact: Copper Alloy
Plating: Gold, Tin or Duplex
*Duplex = Tin on solder, Gold on contact area
Insulator: LCP (black) UL 94V-0

Operating temperature: -55°C to +125°C
Processing temperature: +260°C +0/-5°C for 10 seconds

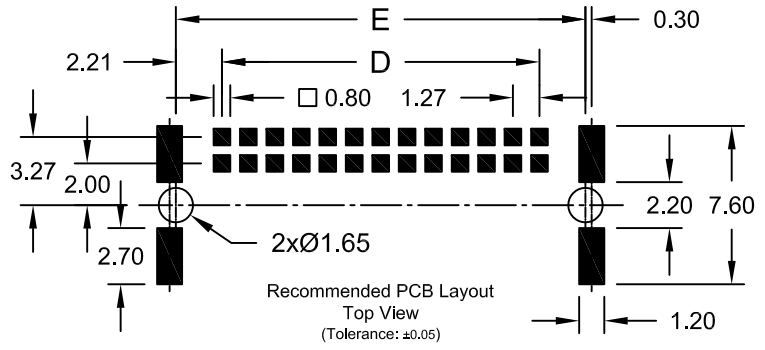

E-tec 2017 © - all rights reserved



UNIT mm	GENERAL TOLERANCE		DRAWN	DATE	DWG. NO.	SHEET 1/1
	X.° ±	X. ±	Ronny	10.01.2017	MBC-QFH38/11	REV. A
	.X° ±	.X ±	CHECK	10.01.2017	SERIES NO.	
	.XX° ±	.XX ± 0.25	APPROVE	10.01.2017	MBC-xxx-QFH38-xx/11X	
.XXX° ±	.XXX ±	Hogi				
SCALE Free						

Multi BUS/Backplane Connector
Q-Type Female SMT horizontal
1.27mm pitch height - 3,85mm
compatible to ERNI INTERact® Series SMC Type